

HOW TO SET THE POWER PLUS TEMPERATURE PROBE

TO SET POWERPLUS™ TEMPERATURE PROBE



Step 1

1. Ensure the oven is turned OFF. Place prepared food on the desired oven rack position. Insert the probe into the food and slide rack into the oven.
2. Plug the connector end of the probe into the probe receptacle at the top of the oven.

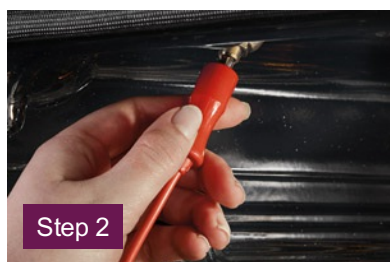

Step 2

When the probe is inserted, an acceptance chime will sound and the probe icon will appear in the display.

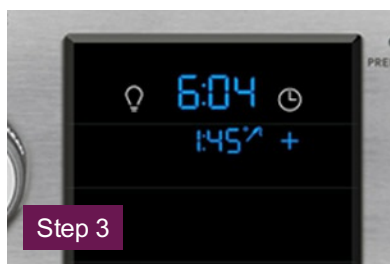

Step 3

3. Press the + key to set the desired food temperature between 140°F and 210°F. If no selection is made within 10 seconds, the control will automatically set the default temperature of 170°F and the display will sound an acceptance chime.
4. Set the oven mode knob to POWERPLUS™ PREHEAT, BAKE, CONVECT BAKE, or CONVECT ROAST.
5. Set the oven temp knob to the desired cooking temperature to begin heating. An arrow and the current meat temperature will appear in the display until the target temperature is reached.



Step 4

When 75% of the target temperature is reached, the oven will chime and a CHECK FOOD reminder will appear in the display. CHECK FOOD will remain in the display and continue to chime every 60 seconds for five minutes or until the oven door is opened.



Step 5

6. Once the target temperature of the food is reached, the oven will chime to signal the end of cooking. At this time the oven will turn off.



FOR GREAT RECIPES USING THIS FEATURE VISIT,
[HTTP://WWW.FRIGIDAIRE.COM/COLLECTIONS/HOW-TO/HOW-TO-TEMPERATURE-PROBE](http://www.frigidaire.com/collections/how-to/how-to-temperature-probe)